

e-pro - System III ICF

Compatible with ICF • Excellent Bonding • Monolithic • Additional Protection • Redundancy



System Description

System III ICF is a field installed composite waterproofing system comprised of a water-based polymer modified asphalt (PMA) membrane laminated to a polyolefin geomembrane covered by an HDPE core with polypropylene fabric drainage composite which provides exceptional water and backfill protection.

System Components

Ecoline-S or R (Interior Course): A spray, fluid applied, water-based polymer modified asphalt (PMA) membrane.

Ecoshield-E (Middle Course): A tough polyolefin geomembrane.

Ecodrain-E (Exterior Course): A HDPE core and non-woven polypropylene fabric drainage composite

Additional Information

Specifications: ICF Specification

Detail Drawings - Reference all WP labeled drawings.

Installation Guidelines - Reference 1. Ecoline-S & R Installation (Vertical Wall) 2. Waterproofing Membrane Repair 3. Ecoshield Installation and Repair 4. Ecodrain Installation and Repair.

Product Information - Reference Ecoline-S, Ecoline-R, Ecoshield-E, and Ecodrain-E or S product brochures.



Compatible with ICF - the water-based technology of the composite system does not harm the insulated concrete form.

Excellent Bonding - the polymeric make up of the waterproofing membrane provides excellent adhesion to the insulated concrete form (ICF) surface.

Monolithic - The fluid applied waterproofing membrane provides a completely seamless barrier.

Additional Protection - The HDPE and polyolefin products protect from root systems and ground chemicals.

Redundancy - Multiple waterproofing, protection and drainage courses provide superior backfill and long term water protection.

e-pro™
Waterproofing Systems



800-882-1896 • www.eproserv.com

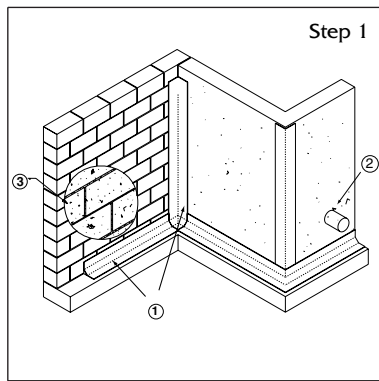

- 1.) Cold Joint
- 2.) Penetration
- 3.) Ties & Joints

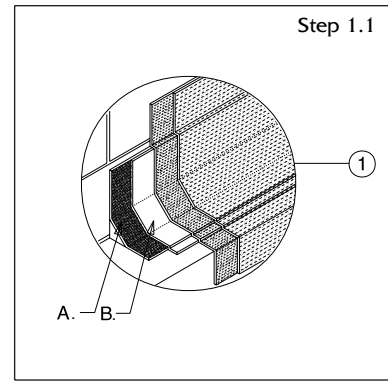

- A.) Ecoline R or T
- B.) Polyester

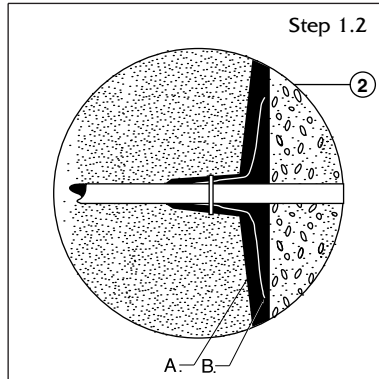

- A.) Ecoline R or T
- B.) Polyester

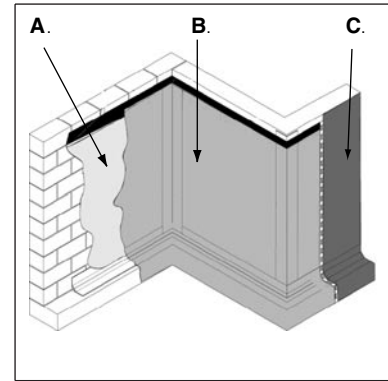

- A.) Ecoline R or S
- B.) Ecoshield
- C.) Ecodrain E

epro - System III ICF

Epro ICF Waterproofing System Testing

Water-based polymer modified asphalt (PMA) membrane laminated to a polyolefin geomembrane which is covered by HDPE core with polypropylene fabric drainage composite which provides exceptional water and backfill protection. (Ecoline-S or R / Ecoshield-E / Ecodrain-E)

Tensile Strength*	ASTM D-412	662 psi
Elongation*	ASTM D-412	45%
Adhesion to Concrete***	ASTM C-836	11 lbf/in
Adhesion to Film	ASTM C-836	28.363 lbf/in
Puncture Resistance	ASTM D-1709	123 lb.
Soil Burial*	ASTM D-4068	
Weight change	See Note 1	1.2% passed
Tensile Strength	See Note 1	9.89% passed
Elongation	See Note 1	2.2% passed
Heat Aging*	ASTM D-4068	
Tensile Strength	See Note 1	8.6% passed
Elongation	See Note 1	8.9% passed
Environmental Stress Cracking* ..	ASTM D-1693	
Failure	See Note 2	620 hrs. passed
Oil Resistance*	ASTM D-543 & ASTM D-412	
Weight change	See Note 1	7.6% passed
Tensile Strength	See Note 1	1.1% passed
Elongation	See Note 1	4.4% passed
Methane Transmission*	ASTM D-1434	
See Note 3		3.70xE-15... passed

* Tests performed by SGS / US Testing
 ** Tests performed by TRI Environmental
 *** Tests performed by Momentum Technologies

Note 1: LA requires less than 10%
 Note 2: LA requires over 500 hrs.
 Note 3: LA requires less than 3 ml per day

Chemical Permeation**	ASTM F-739	Perm Rate	Perm Rate
		Ug/cm2	ml/day
Chlorinated Solvent			
Perchloroethylene		69.4	0.0008
Trichloroethylene		89.8	0.0012
Aromatic Hydrocarbon			
Benzene		59.3	0.0013
Chemical Resistance**	ASTM D-543	Net change	
Chlorinated Solvents	ASTM D-882 Mod. (Less 10% pass)		
Perchloroethylene			
Weight		4.1%	
Tensile Strength		6.5%	
Trichloroethylene			
Weight		5.4%	
Tensile Strength		6.0%	
Aromatic Hydrocarbon			
Benzene			
Weight		4.1%	
Tensile Strength		4.4%	
Gases			
Hydrogen Sulfide			
Weight		0.6%	
Tensile Strength		0.8%	



800-882-1896 • www.eproserv.com